

Quick Start and Regulatory Guide

C-One² e-ID

QSG 190087 A00

COPPERNIC
MOBILITY | CONNECTED DATA | ANALYTICS



one²
e-ID
by Coppernic

- Non contractual picture -

Les Fontaines de la Duranne
185 avenue Archimède 13857 Aix-en-Provence FRANCE
T. +33 (0)4 42 65 25 65 F. +33 (0)4 42 51 57 32

coppernic.fr

SAS AU CAPITAL DE 100 000 EUROS • RCS : AIX 509 059 572
SIRET : 509 059 572 00016 • APE 6201Z • TVA : FR 58 509 059 572

Quick Start and Regulatory Guide

C-One² e-ID

PRODUCT OVERVIEW

FRONT, RIGHT & TOP VIEWS



Quick Start and Regulatory Guide

C-One² e-ID

LEFT, BACK & BOTTOM VIEWS



Quick Start and Regulatory Guide

C-One² e-ID

Setting up your phone

CAUTION

Failure to completely reseal the SIM/microSD card slot cover may lead to water or other liquids entering the casing, which may cause damage to the phone.

MICRO SIM CARD INSTALLATION

- Open Micro SD/Micro SIM door.
- To remove the Micro SIM card: Insert a removal tool (pin type) into the hole then push until the tray pops out.
- Put the Micro SIM card on the tray.
- Insert Micro SIM tray into SIM slot.
- Close the door after installation.

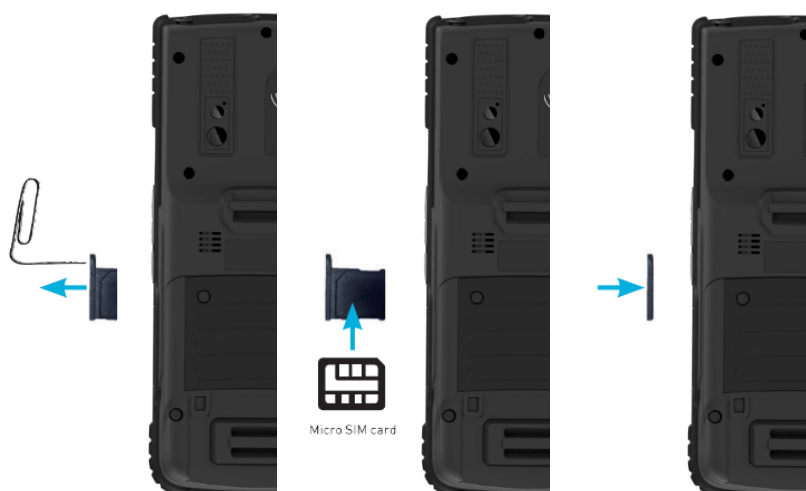

MICRO SD CARD INSTALLATION

- Open Micro SD/Micro SIM door.
- Insert Micro SD card into Micro SD card slot.
- Close the door after installation.

NOTE: Micro SIM card and Micro SD card should be purchased separately.



Quick Start and Regulatory Guide

C-One² e-ID

CHARGE THE BATTERY

Before using the C-One² e-ID / RAPID2 charge the battery using one of the following accessories approved by COPPERNIC:

1. Micro USB cable + Power Adaptor Jack (included in package) and insert the cable to Micro USB hole.



2. Cradle Charging + DC Power Cable + Power Adaptor Jack





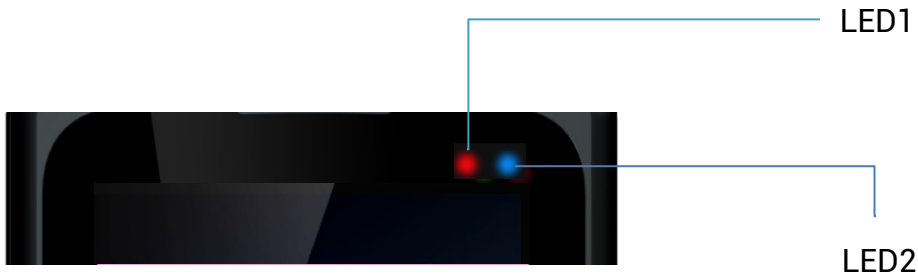

Quick Start and Regulatory Guide

C-One² e-ID

LED INDICATORS



	Red LED blinks (LED1)	Low battery
	Red LED (LED1)	Battery is charging
	Green LED (LED1)	Battery is fully charged
	Blue LED blinks (LED2)	BT devices connected or receiving messages/notifications

CAUTION

Please make sure the device being charged fully when using C-One² e-ID / RAPID2 at first time. Please ensure the Micro USB port clean and dry before inserting a USB cable for charging to avoid the operating issues on the device.

Please remove water or moisture from the Micro USB port instantly with soft cloth when the device gets wet, to avoid the operating issues on the device.

Quick Start and Regulatory Guide

C-One² e-ID

Using Your Phone

TURNING ON/OFF YOUR PHONE

1. To turn on the phone, press and hold the power button during 5s.
2. To turn off the phone, press the power button and select "Power off" in the dialog box.
3. To reset the phone, press and hold the power button during 30s.

NOTE

Device turns to the modes as below by pressing power button key.

- **SUSPEND MODE**

Press and release the power button to place the device in suspend mode. The display will be off and go into a low power state to conserve battery power.

- **REBOOT**

Press and hold the power button and select "Reboot" in the dialog window to restart the device.

DATA CAPTURE (BARCODE SCANNER)

Scan Demo with the Imager

- Install the "Scan SDK" provided separately by COPPERNIC (SDK includes API service and the demo application)

Side-Key Remapping for scanning



- Go to "Settings" → Select "Remap button & Shortcut"
- Select the key (P1, P2- blue side keys) → Tap Remap Key → Tap Barcode Scan
- The red laser aiming pattern turn on to assist in aiming, scan ready when beep sounds.
- Release the scan button.



Quick Start and Regulatory Guide

C-One² e-ID

Using barcode scanning reader as keyboard input:

1. Tap "Demo" apk -> Tap  -> Select "Settings" -> Enable "Keyboard Simulation" to replace physical key input on keyboard with scanning input.
2. Choose barcode symbolizes
Tap "Demo" apk -> Tap  -> Select "Settings" -> Tap "Enable/Disable" under symbology configuration -> Tap "Symbology Config".

NOTE

Please remove the protector film before using scanner.



CAUTION

CLASS 2 LASER WHEN OPEN. DO NOT STARE INTO BEAM OR VIEW WITH OPTICAL INSTRUMENTS. COMPLIES WITH 21CFR1040.10 AND 1040.11 EXCEPT FOR DEVIATIONS PURSUANT TO LASER NOTICE NO. 50, DATED JUNE 24, 2007 AND IEC/EN 60825-1:2014

RFID

For C-One² e-ID / RAPID2, to read put the TAG/CARD on the RFID area.



Quick Start and Regulatory Guide

C-One² e-ID

SMART CARD READER

For C-One² e-ID / RAPID2, to read put the SMARTCARD in the slot.



OCR READER

For C-One² e-ID / RAPID2 with OCR Reader option, to read slide the document in the rail.



Quick Start and Regulatory Guide

C-One² e-ID

PHOTO & VIDEOS

Using the rear camera to take photos and capture video.

1. Go to Home Screen → select "Camera" → Tap camera icon or screen to take a picture/switch to video icon and tap for video recording.
2. Using the rear camera to take photos and capture video.

NOTE

Ensure device memory or extend Micro SD card space is available.



Quick Start and Regulatory Guide

C-One² e-ID

REGULATORY INFORMATION

CAUTION: Only use COPPERNIC approved accessories.

- OPERATING FREQUENCIES

C-One² e-ID / RAPID2

EUT Type	Handheld Device
Brand Name	COPPERNIC / IDEMIA
Model Name	C-ONE ² e-ID / RAPID2
Tx Frequency Bands (Unit: MHz)	GSM900 : 880 ~ 915
	GSM1800 : 1710 ~ 1785
	WCDMA Band I : 1920 ~ 1980
	WCDMA Band VIII : 880 ~ 915
	LTE Band 1 : 1920 ~ 1980
	LTE Band 3 : 1710 ~ 1785
	LTE Band 7 : 2500 ~ 2570
	LTE Band 8 : 880 ~ 915
	LTE Band 20 : 832 ~ 862
	LTE Band 28 : 703 ~ 748
	WLAN : 2412 ~ 2472, 5180 ~ 5320, 5500 ~ 5700
	Bluetooth : 2402 ~ 2480
	RFID options : 13.56MHz / 134.2KHz
	GPS : 1575.42

Quick Start and Regulatory Guide

C-One² e-ID

Maximum AVG Conducted Power (Unit: dBm)	GSM900 : 33.78
	GSM1800 : 31.12
	WCDMA Band I : 23.68
	WCDMA Band VIII : 23.77
	LTE Band 1 : 24.52
	LTE Band 3 : 23.98
	LTE Band 7 : 23.97
	LTE Band 8 : 23.99
	LTE Band 20 : 23.99
	LTE Band 28 : 23.94
	802.11b : 15.83
	802.11g : 16.72
	802.11n HT20 (2.4GHz) : 16.76
	802.11n HT40 (2.4GHz) : 15.83
	802.11a : 15.13
	802.11n HT20 (5GHz) : 15.17
	802.11n HT40 (5GHz) : 15.30
	802.11ac VHT80 : 14.82
	Bluetooth : 2.36

Quick Start and Regulatory Guide

C-One² e-ID

C-One² e-ID /RAPID2(EU) | C-One² e-ID/RAPID2(EUNS)

EUT Type	Handheld Device
Brand Name	COPPERNIC / IDEMIA
Model Name	C-ONE ² e-ID/RAPID2(EU) C-ONE ² e-ID/RAPID2(EUNS)
Tx Frequency Bands (Unit: MHz)	GSM900 : 880 ~ 915
	GSM1800 : 1710 ~ 1785
	WCDMA Band I : 1920 ~ 1980
	WCDMA Band VIII : 880 ~ 915
	LTE Band 1 : 1920 ~ 1980
	LTE Band 3 : 1710 ~ 1785
	LTE Band 7 : 2500 ~ 2570
	LTE Band 8 : 880 ~ 915
	LTE Band 20 : 832 ~ 862
	LTE Band 28 : 703 ~ 748
	WLAN : 2412 ~ 2472, 5180 ~ 5320, 5500 ~ 5700
	Bluetooth : 2402 ~ 2480
	GPS : 1575.42

Quick Start and Regulatory Guide

C-One² e-ID

Maximum AVG Conducted Power (Unit: dBm)	GSM900 : 33.78
	GSM1800 : 31.12
	WCDMA Band I : 23.68
	WCDMA Band VIII : 23.77
	LTE Band 1 : 24.52
	LTE Band 3 : 23.98
	LTE Band 7 : 23.97
	LTE Band 8 : 23.99
	LTE Band 20 : 23.99
	LTE Band 28 : 23.94
	802.11b : 15.83
	802.11g : 16.72
	802.11n HT20 (2.4GHz) : 16.76
	802.11n HT40 (2.4GHz) : 15.83
	802.11a : 15.13
	802.11n HT20 (5GHz) : 15.17
	802.11n HT40 (5GHz) : 15.30
	802.11ac VHT80 : 14.82
Bluetooth : 2.36	

Quick Start and Regulatory Guide

C-One² e-ID

NOTE

C-ONE² e-ID / RAPID2: Maximum reported SAR value (10g) Body: 1.71W/kg @5mm

C-ONE² e-ID / RAPID2 (EU): Maximum reported SAR value (10g) Body: 1.99W/kg @5mm

1. WIRELESS DEVICE COUNTRY APPROVAL

Regulatory markings, subject to certification, are applied to the device signifying the radio(s) are approved for use in the European countries under CE coverage.

For 2.4GHz or 5GHz products : Europe includes Austria, Belgium, Bulgaria, Czech Republic, Cyprus, Denmark, Estonia, Finland, France, Germany, Greece, Hungary, Iceland, Ireland, Italy, Latvia, Liechtenstein, Lithuania, Luxembourg, Malta, Netherland, Norway, Poland, Portugal, Romania, Slovak Republic, Slovenia, Spain, Sweden, Switzerland and the United Kingdom.

CAUTION : Operation of the device without regulatory approval is illegal.

2. GPS INFORMATION

- Acquiring satellite signals may take a few minutes.
- Without a clear view, acquisition takes longer and possible unable to catch the position quickly.
- Turn off GPS application if no use.

3. COUNTRY ROAMING

This device incorporates the international roaming feature which will ensure the product operates on the correct channels for the particular country of use.

4. AD-HOC OPERATION (5GHZ BAND)

Ad-Hoc operation is limited to Channels 36- 48 (5150 – 5250 MHz). Use of this band is restricted to indoor use only, any other use will make the operation of this device illegal.

Quick Start and Regulatory Guide

C-One² e-ID

WARNINGS OF USE WIRELESS DEVICES

Please observe warning notices with regard to the usage of wireless devices.

1. POTENTIALLY HAZARDOUS ATMOSPHERES – VEHICLES USE

You are reminded of the need to observe restrictions on the use of radio devices in fuel depots, chemical plants etc. and areas where the air contains chemicals or particles (such as grain, dust, or metal powders) and any other area where you would normally be advised to turn off your vehicle engine.

2. SAFETY IN AIRCRAFT

Turn off your wireless device whenever you are instructed to do so by airport or airline staff.

3. SAFETY IN HOSPITALS

Wireless devices transmit radio frequency energy and may affect medical electrical equipment. Wireless devices should be switched off whenever you are requested to do so in hospitals, clinics or healthcare facilities. These requests are designed to prevent possible interference with sensitive medical equipment.

SAFETY INFORMATION – EUROPE

This device was tested for typical body-worn operation. Use only COPPERNIC tested and approved accessories to ensure EU compliance.

LASER DEVICES

Class 2 laser scanners use a lower power, visible light diode. As with any very bright light source, such as the sun, the user should avoid staring directly into the light beam. Momentary exposure to a class 2 laser is not known to be harmful.

CAUTION: Use of controls, adjustments or performance of procedures other than those specified herein may result in hazardous laser light exposure.

POWER ADAPTOR

1. Use only a C-ONE² e-ID / RAPID2 approved Power Adaptor with electrical ratings: Output 5VDC, min 2A, with a maximum ambient temperature of at least 45°C.
2. Use of alternative power adaptor will invalidate any approvals given to this device and maybe dangerous.

BATTERY INFORMATION

Use only a COPPERNIC approved batteries.

When devices are stored over six (6) months without use, some irreversible deterioration in overall battery quality may occur. Store devices at half of full charge in a dry, cool place. When storing devices for one year or longer, the charge level of battery should be verified at least once a year and charged to half of full charge.

Quick Start and Regulatory Guide

C-One² e-ID

BATTERY SAFETY

1. The area in which the units are charged should be clear of debris and combustible materials or chemicals. Particular care should be taken where the device is charged in a non-commercial environment.
2. Follow battery usage, storage, and charging guidelines found in the user guide.
3. Improper battery use may result in a fire, explosion, or other hazard.
4. To charge the device battery, the battery and charger temperature must be between 0°C~+45°C.
5. Do not use incompatible batteries and chargers. Use of an incompatible battery or charger may present a risk of fire, explosion, leakage, or the hazard.
6. Do not disassemble or open, crush, bend or deform, puncture, or shred the device.
7. Severe impact from dropping any battery-operated device on a hard surface could cause the battery to overheat.
8. Do not short circuit a battery or allow metallic or conductive objects to contact the battery terminals.
9. Do not modify or remanufacture, attempt to insert foreign objects into the battery, immerse or expose to water or other liquids, or expose to fire, explosion, or other hazard.
10. Do not leave or store the equipment in or near areas that might get very hot, such as in a parked vehicle or near a radiator or other heat source. Do not place battery into a microwave oven or dryer.
11. Battery usage by children should be supervised.
12. Please follow local regulations to promptly dispose of used re-chargeable batteries.
13. Do not dispose of batteries in fire.
14. Seek medical advice immediately if a battery has been swallowed. In the event of a battery leak, do not allow the liquid to come in contact with the skin or eyes. If contact has been made, wash the affected area with large amounts of water and seek medical advice.

Quick Start and Regulatory Guide

C-One² e-ID

FREQUENCY OF WLAN OPERATION

The use of 2.4 GHz WLAN's, for use through the EEA, have the following restrictions:

1. Maximum radiated transmit power of 100 mW EIRP in the frequency range 2.400 - 2.4835 GHz.
2. France, outside usage is restricted to 2.4 - 2.454 GHz.
3. Italy requires a user license for outside usage. Bluetooth® Wireless Technology for use through the EEA has the following restrictions:
 4. Maximum radiated transmit power of 100mW EIRP in the frequency range 2.400 -2.4835 GHz
 5. France, outside usage is restricted to 10mW EIRP.
 6. Italy requires a user license for outside usage.
 7. The device is restricted to indoor use only when operating in the 5150 to 5250 MHz frequency range.
 8. Ad-Hoc Operation (5GHz Band).
 9. Ad-Hoc operation is limited to Channels 36 - 64 (5150 – 5350 MHz). Use of this band is restricted to indoor use only, any other use will make the operation of this device illegal.

This device complies with Directive 2014/53/EU issued by the Commission of the European Community.

	AT	BE	BG	HR	CY	CZ	DK
	EE	FI	FR	DE	EL	HU	IE
	IT	LV	LT	LU	MT	NL	PL
	PT	RO	SK	SI	ES	SE	UK

Copyright© 2019 COPPERNIC. All rights reserved.